



Field Club of Omaha
 Omaha, Nebraska
 Conceptual Bike/Hike Trail Plan along Center Street

Drawn: BJH
 Checked: TJC
 Date: March 14, 2019

Bicycle/Pedestrian Trail Addition Along Center Street

MARCH 2019
 Field Club of Omaha



FIELD CLUB
 OF OMAHA

Executive Summary

Bicycle/Pedestrian Trail Addition Along Center Street

Field Club of Omaha has held several neighborhood association meetings starting in Fall 2018 about the possibility of closing Woolworth Avenue. In conversations with our area neighbors and stakeholders it was identified that the loss of vehicular access was not nearly as important as the loss of the bicycle and pedestrian access; specifically, the access from 36th to the Field Club Trail. In response to this concern, the Club has proposed the following trail addition along Center Street on the southern edge of the Club's property. This trail would be built by the Club, on current Club property, for the benefit and access of the general public. Further, the Club would maintain this section of the trail moving forward. A further explanation of the trail and its design is listed below.

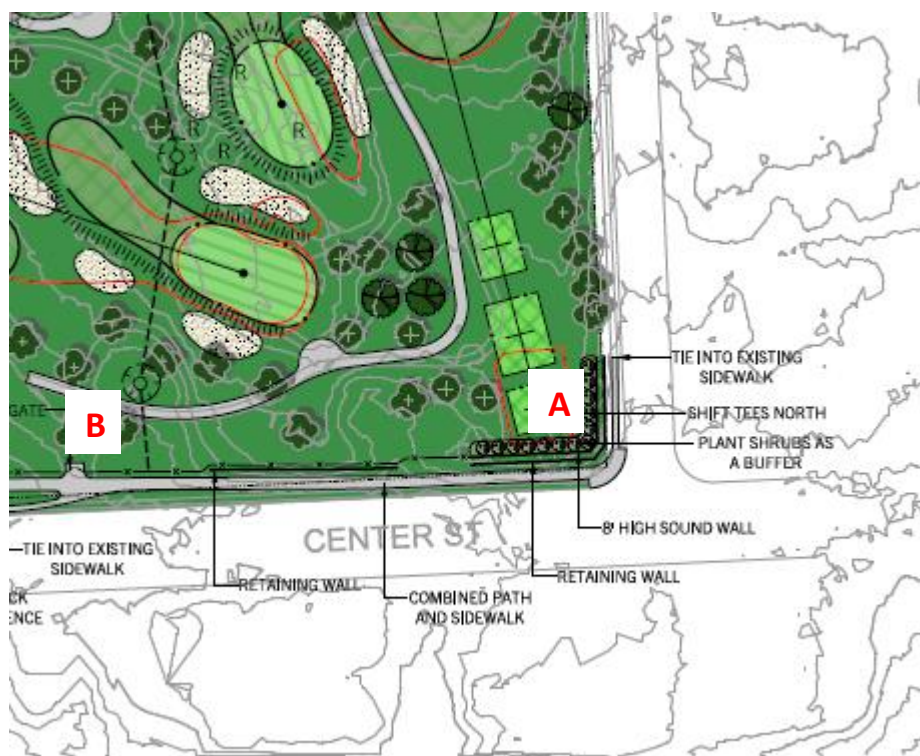

A. This is the corner of 36th and Center Street. Currently the sidewalk along Center butts directly against Center Street and is a dangerous sidewalk for pedestrians, but especially bicycle traffic. This plan proposes to widen the path to an 8-foot concrete path and move it away from Center Street traffic.

B. This trail addition would be ADA compliant with a gradually descent starting 100 yards (300 feet) from the corner of 36th and Center. At this location, there would be an intersection providing an option to either stay along Center Street on the existing sidewalk or start the descent down to the Field Club Trail.

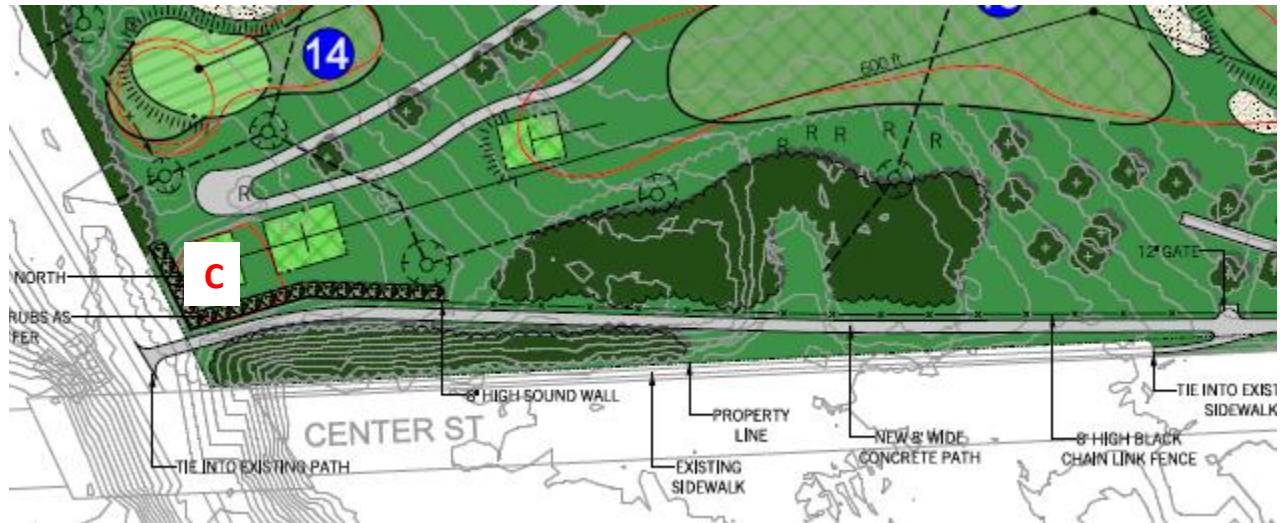

- C. The trail would gradually descend to the Field Club trail with ADA complaint grade. A retaining wall would be built to ensure safety around the trail. The proposed trail addition would tie in directly to the existing Field Club Trail on the western edge of the Club's current property.

To complete this project in an appropriate manner, the Club will shift the green complex of #14 along with the tee complexes of holes 15 and 16. It is the Club's hope this Trail would be an added benefit to replace the existing access along Woolworth Avenue should Woolworth be closed. This Trail is conceptual in nature and will change from time to time as ideas/comments warrant further improvement. The Club is committed to devoting land, building the Trail and maintaining it in the future should Woolworth close. Should Woolworth remain open moving forward it is the Club's intention to not move forward with the Trail plan.